

## HOW TO MEASURE - FACE FIT

### How to Measure for a Face Window

You will need a Metal tape measure (not cloth as it may stretch), ladder, pen and paper.  
We recommended that you measure in millimetres (mm).



### Face (Outside Window Frame)

#### Measuring for an architrave

This is where the Roller Blind is fitted to the window's architrave.

- « Width – Measure the width from the outer edge of the architrave to the opposite outer edge.
- « Drop – Measure the drop from the top of the architrave to where you want the blind to finish.

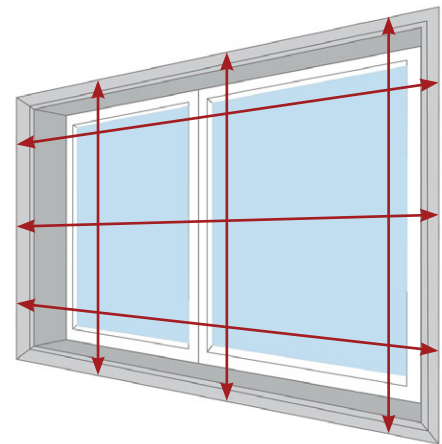

#### Measuring for a Square Set

This is where the Roller Blind is fitted outside the window recess, overlapping on all sides. Measures the size of the recess and add extra on all sides to ensure adequate coverage:

- « Width – Measure the exact size of the area you would like the blind to overlap. To minimise light leakage, ensure the blind overlaps the window recess by at least 70mm at the top and 50 mm at the side.
- « Drop – Measure the drop from top the top of where the blind will be fitted to where you want the blind to finish.

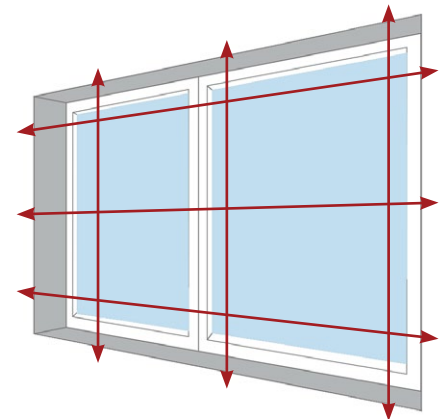

### Important Notes

- « On a Roller Blind with width of the fabric will be approximately 30mm narrower than the outside bracket to outside bracket measurement.
- « Please ensure when measuring you look for **any obstructions such as door or window handles**, locks, etc. This will allow your blind to move freely.
- « If your blind needs a control, make sure it's on the window opening side.
- « **Double check the measurements before submitting your order.**

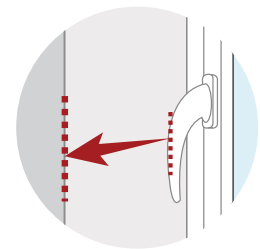

Still not 100% confident with your measurements, please give us a call and talk to one of our dedicated specialists by calling 1300 614 797. Or [mega-diy-blinds@carpetcall.com.au](mailto:mega-diy-blinds@carpetcall.com.au)